

Insulating glass unit tempered  
 outer glass and laminated inner glass  
 Thickness 32mm

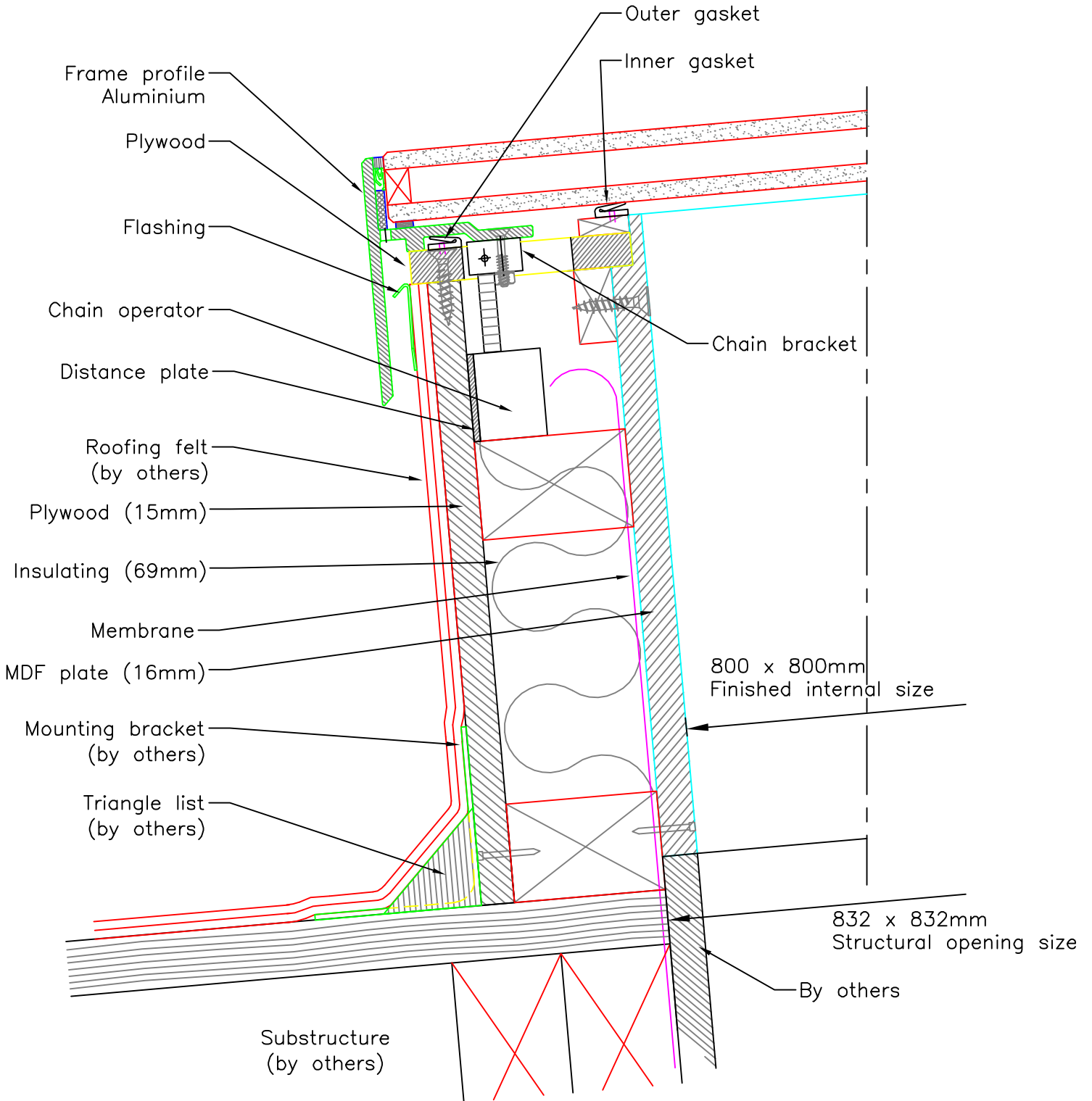

National Domelight Company  
 Pyramid House, 52 Guildford Road, Lightwater  
 Surrey, GU18 5SD  
 Tel: 01276 451555  
 Fax: 01276 451533  
 E-mail: info@nationaldomes.com  
 Website: www.nationaldomes.com