

Please ensure there is a pitch of between 4 and 15 degrees built into the kerb to help prevent water ponding.

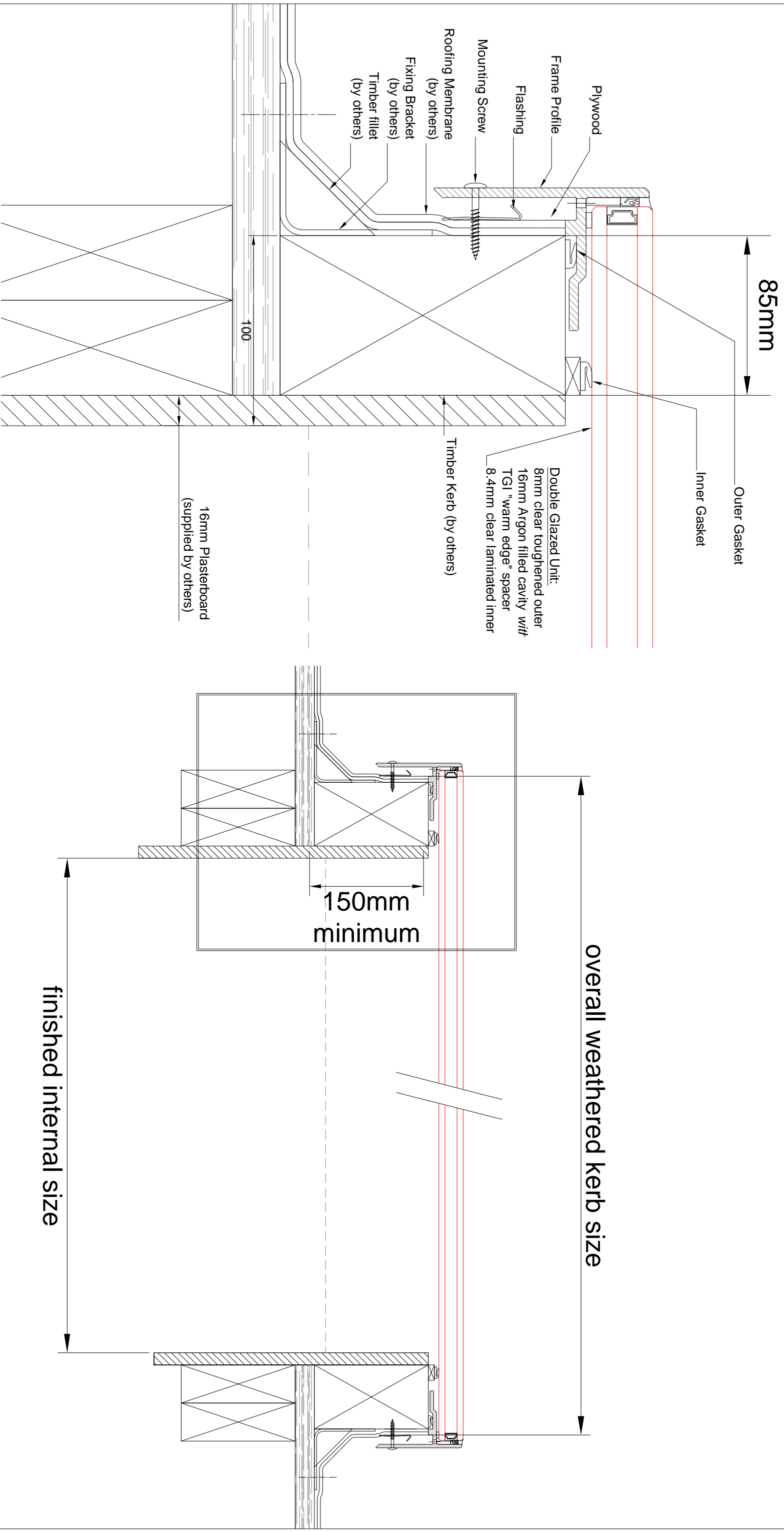

DO NOT SCALE

National Dometight Company
 Pyramid House, 52 Guildford Road, Lightwater, Surrey, GU18 5SD
 Tel: 01276 451555
 Fax: 01276 451533
 E-mail: info@nationaldomes.com
 Website: www.nationaldomes.com

Title	Solarglaze Fixed Top Only

