

Factory glazed frame constructed from extruded aluminium profile, thermally broken with polyamide insulation sections. Supplied as standard polyester powder coated to dual colour finish. RAL 9010 (White) to internal section and RAL 9005 (Black) to external section.

Extruded aluminium 'clip-on' capping profile, supplied as standard polyester powder coated to RAL 9005 (Black).

47.5mm Insulating glass unit, comprising of:
 25.5mm Toughened heat soaked and laminated outer pane,
 16mm Argon filled cavity (Silicone sealed),
 6mm Clear toughened super low-E inner pane.

Plasterboard engages with skylight framework at unique Decorstop detail, minimising internal sight lines.

Fully insulated upstand supplied by Skylglaze. Constructed from 2No. skins of 9mm Stirling board, whitewood framing and Iso wool insulation.

12.7mm Plasterboard and Skim (By Others)

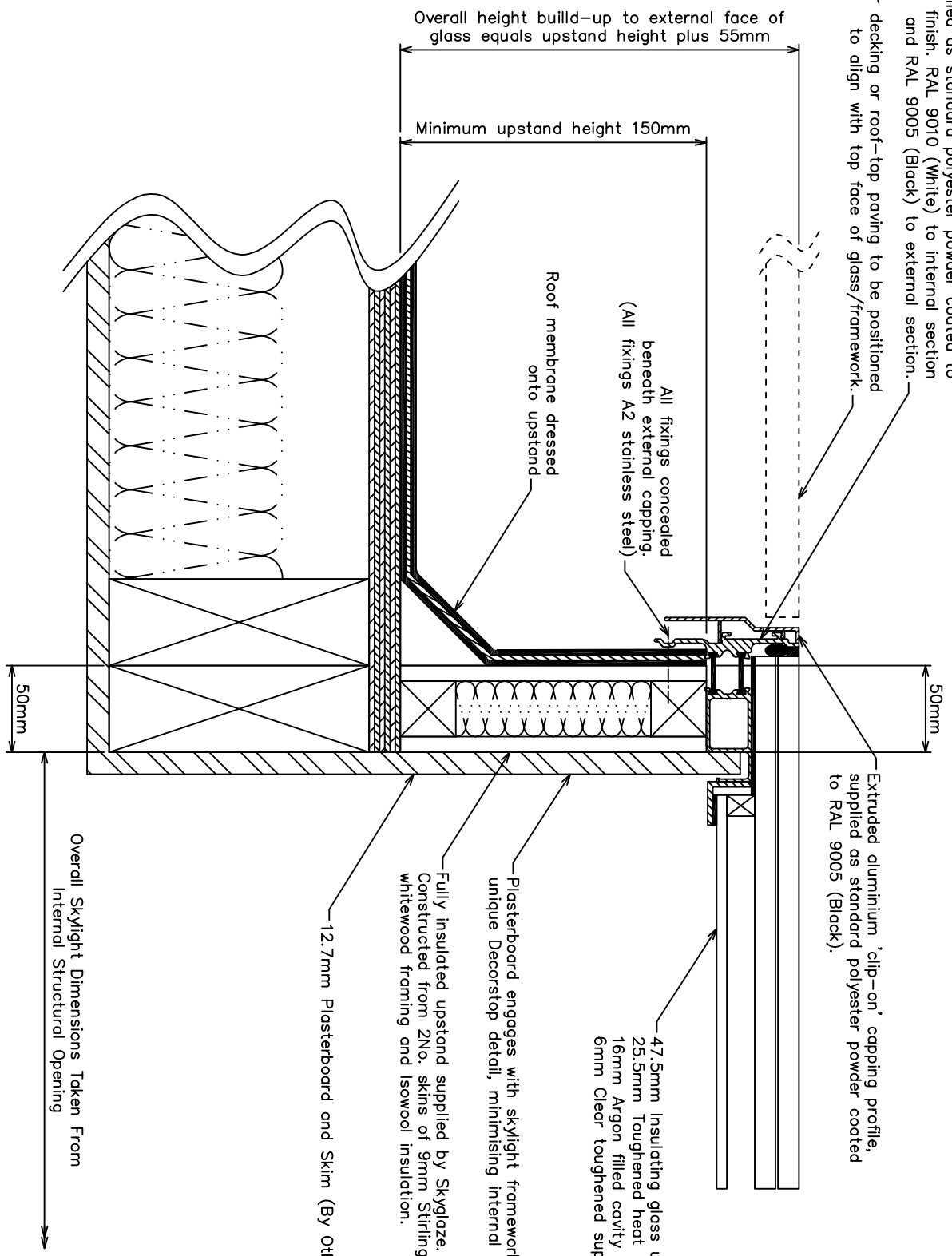

Section Through Upstand/Framework Construction



National Domelight Company
 Tel: 01276 451555
 Fax: 01276 453666
 info@nationaldomes.com
 www.nationaldomes.com

Rev:	Description:	By:	Date:	Tolerances:	Drawn:	Finish:	Project Ref:
				X ± 0.5mm X.X ± 0.25mm X.XX ± 0.10mm angles ± 0.5°	JB Date: Oct 2005	Not Applicable Materials: Not Applicable	Skyglaze Walk On Description/Location:
				DO NOT SCALE	Third angle projection	Quantity: Not Applicable	Dwg No.: WO-STD-002